

SUNLIGHT SVT 2V - 400Ah

AGM VRLA Battery

Features & Benefits

- Non-spillable maintenance free product
- High Quality and High Reliability
- Wide range of operating temperature
- Fast and easy installation
- Low self discharge
- Long service life, float or cyclic applications
- Female M8 brass terminals
- IEC 60896-21 & 22, EN 50272-2 compliant
- Can be mounted in any orientation (not upside down)
- Fully recyclable product

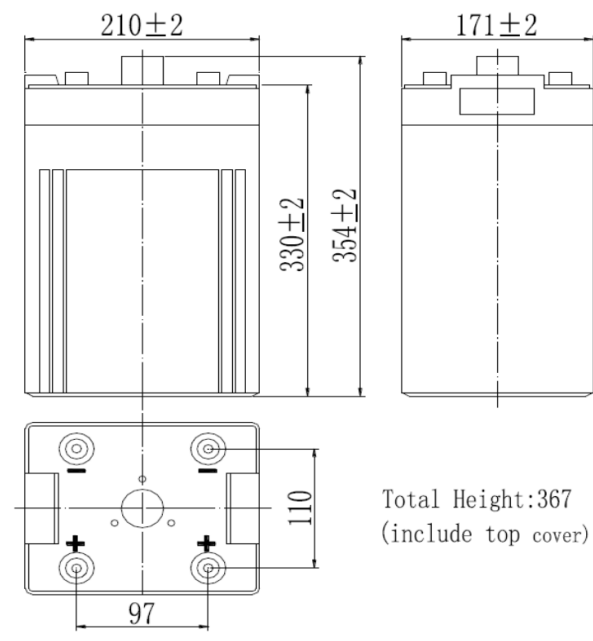

Performance Data

Specifications

Nominal Voltage	2 V	
Number of cells	1	
Design Floating Life (20°C)	15 years	
Dimensions	Length	210 mm
	Width	171 mm
	Height	330 mm
Weight	Total Height	367 mm
		24.2 kg
Nominal Capacity	10 hours rate (1.80)	400 Ah
	5 hours rate (1.75)	356 Ah
	1 hour rate (1.65)	238 Ah
Internal Resistance (fully charged, 25°C)	0.6 mOhm	
Self Discharge	approx. 3% per month at 25°C	
Nominal Operating Temperature	25°C	
Operating Temperature range	Discharge	-15°C to 50°C
	Charge	-10°C to 50°C
	Storage	-20°C to 50°C
Float Charging Voltage	2.25 to 2.30 V/cell at 25°C	
	Temperature compensation	-18mV/°C
Maximum charging current	80 A	
Maximum discharge current	2800 A (5 sec.)	

Discharge Constant Current at 25°C (Amperes)

End Voltage V/cell	30min	1h	2h	3h	4h	5h	6h	8h	10h	20h	24h
1.60 V	364	242	146	104	84.0	72.6	62.4	49.0	40.7	21.4	18.6
1.65 V	356	238	146	103	83.2	72.2	62.1	48.6	40.6	21.4	18.5
1.70 V	345	233	144	102	82.4	71.7	61.6	48.3	40.6	21.3	18.4
1.75 V	337	228	142	102	82.4	71.2	61.2	48.0	40.3	21.1	18.3
1.80 V	325	221	138	99.2	79.5	69.0	59.4	46.6	40.0	21.0	18.2

Discharge Constant Power at 25°C (Watts)

End Voltage V/cell	30min	1h	2h	3h	4h	5h	6h	8h	10h	20h	24h
1.60 V	680	461	282	204	164	143	123	97.6	80.8	42.7	37.3
1.65 V	667	454	281	202	163	142	122	96.8	80.8	42.6	37.2
1.70 V	645	442	278	202	162	142	122	96.0	80.8	42.6	37.0
1.75 V	631	434	274	200	161	140	121	95.2	80.0	42.3	36.8
1.80 V	607	420	267	194	156	136	117	92.8	79.6	42.0	36.6

Note: The above characteristics data can be obtained within three charge/discharge cycles.